

OWN a NEW Home for  
only ...

\$434.54 per month\*  
for  
180 months

\*Payment does not include taxes and insurance and actual payment will be higher.

# SMART START Loan Program

Erin Estates MHC  
1356 Breesport Rd. Lot 101  
Erin, NY 14838

Inv. #21314  
Commodore Ts503a  
3 Bed/2 Bath - 14' x 68'



Sale Price** (including tax) .....	\$ 42,884.00
Down Payment** .....	\$ 4,288.40
Loan Amount** (includes 2 pts origin fee) .....	\$ 40,436.89
Interest Rate** .....	10.00%
Annual Percentage Rate (APR)** .....	10.83%
Estimated Monthly Loan Payment** .....	\$ 434.54
Site Rent** .....	\$ 380.00
Estimated TOTAL Payment** .....	\$ 814.54



## Why SMART START ?...

Don't pay more for a traditional loan!

- ALL credit scores accepted!
- Most applicants approved!
- Lowest rates offered by 21st Mortgage<sup>#</sup>
- Low down payment required!<sup>#</sup>
- Energy Efficient NEW homes = Huge monthly savings to you!
- Your Manufactured Home Community is investing in your home ownership!

<sup>#</sup>Compared to standard rates available from 21st Mortgage for homes sold in the

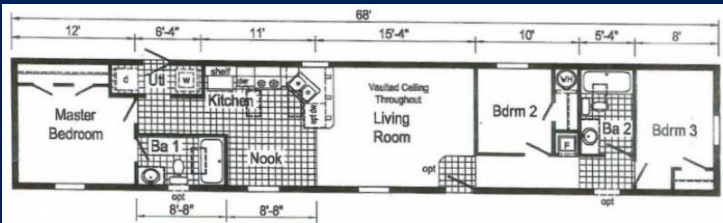

Representative only; actual models may vary.

\*\* Estimates only. This is not a credit decision or commitment to lend. Actual term, rate, APR, sales price, loan amount, and down payment may vary. Actual payments may vary. Rates are subject to change. Total Estimated Monthly Payment based on Monthly Loan Payment plus estimated monthly site rent. Estimate does not include taxes or insurance and actual payment will be higher. All tax references are regarding property taxes. Program terms are only available in select manufactured home communities.

6/5/2018



Equal Housing Lender. 21<sup>st</sup> Mortgage Corporation, 620 Market Street, Knoxville, TN 37902, (865) 523-2120. NMLS 2280. Trade/service marks are the property of 21<sup>st</sup> Mortgage Corporation and/or its subsidiaries. AZ - Mortgage Banker BK-0907006. CA - Loans made or arranged pursuant to a California Finance Lenders Law License. CO Lic. #987899. In CO check the license status of your mortgage loan originator at <http://www.dora.state.co.us/real-estate/index.htm>. (CO responsible party: 21st Mortgage Corp., NMLS 2280. Regulated by the Division of Real Estate.) GA - Georgia Residential Mortgage Licensee 12375. IL - Illinois Residential Mortgage Licensee # MB.6760637 licensed by the Illinois Department of Financial and Professional Regulation - Division of Banking, 122 South Michigan Avenue, Suite 1900, Chicago Illinois 60603, (312) 793-3000 MT -Mortgage Lender, Mortgage Servicer and Sales Finance Licenses, #2280. MS - Mississippi Licensed Mortgage Company. NH - Licensed by the New Hampshire Banking Department. NY - Licensed Mortgage Banker-NYS Banking Department. OR - Oregon Mortgage Lender License ML-1428. PA - Licensed by the Department of Banking, Licensing Division Market Square Plaza 17 N. Second Street, 13th Floor Harrisburg, Pennsylvania 17101 (800) 722-2657 Mortgage Consumer Discount Company License 20867. TX -SML Mortgage Banker Registration, Regulated Loan License 2178-8836. VA - NMLS ID#2280 ([www.nmlsconsumeraccess.org](http://www.nmlsconsumeraccess.org)), WA - Consumer Loan License CL-2280. Other terms and conditions may apply. Not all products are available in all states. Call for details. 01/07/2015.